

Gebrauchsanweisung
Instructions for use
Mode d'emploi
Gebruiksaanwijzing
Istruzioni per l'uso

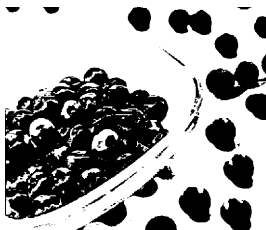

Brugsanvisning
Bruksanvisning
Käyttöohje
Manual de utilizagão
Instrucciones para el uso



C



05nviE?
Instrukcje uzytkowania
Használati utasitás



Nàvod pouziti
Nàvod na pouzitie
Instrucjiuni de utilizare
no

-
-

-
-
-
-

-

-
-
-

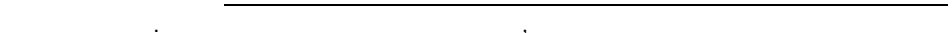

-

-

-

-

-

-

-

-

.(.1)

.(.2)

.(.3)^



.1



.2

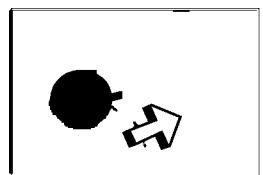

.3

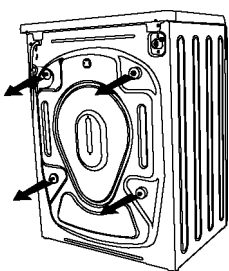

-
-
-
-
-
-
-
-

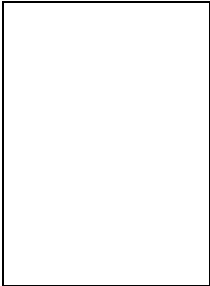

-
-

220-240

50

10

10

-

-

() ()

-

).

(

-

1 () 2 (

)

•
(
).

1-10 (0,1-1,0)
(1)
).

8

3/4"
Вход холодной воды (Клапан с белым фильтром)

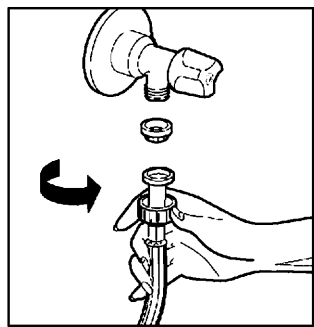
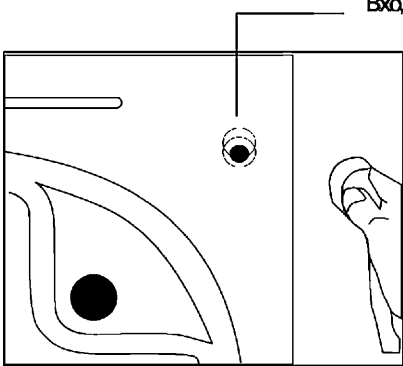

•
•
100

60

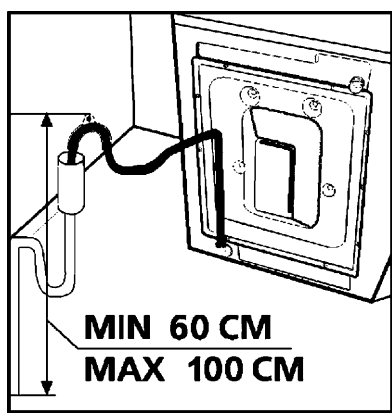

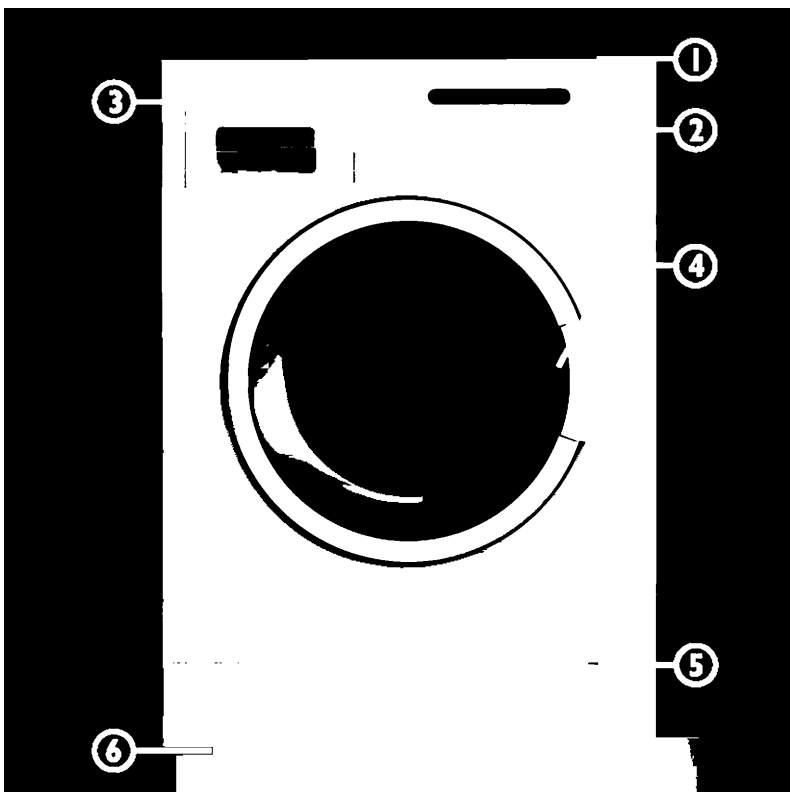

- 1 -
- 2 -
- 3 -
- 4 -
- 5 -
- 6 -

-
-

2

90°

(, , .),

-
-
-
-
-
-
-
-
-

^^^

90°

60°

30°

-
-
-
-
-

•

2

•

1 / 4

1

•

2.

•

•

•

•

•

!

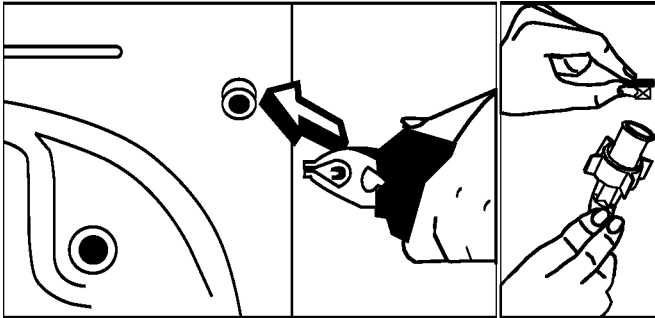

!

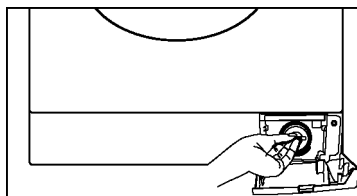
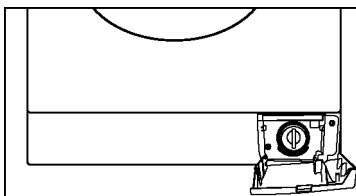
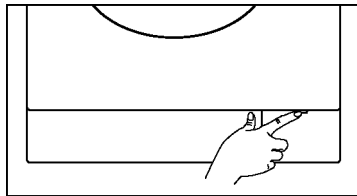
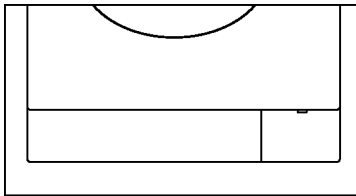

()

(.1)

(.2)



Рис. 1



Рис. 2

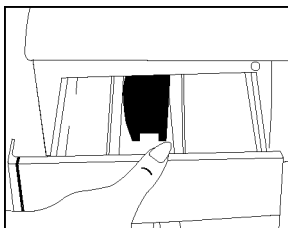

!

0° ,

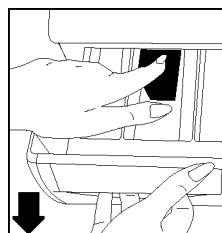
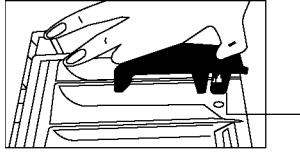
-
-
-
-
-
-
-

)

“ ”
“ / ”
(

0° .

!

-
-
-

| | | |
|--|----------|--------|
| | | |
| | | |
| | | |
| | | |
| | « / ». | « / ». |
| | (). «0» | |
| | | |
| | | |
| | | |
| | | .* |
| | | .* |
| | | |
| | | |
| | | |

(*) ,
 (**) ,

| | | |
|--|--|------------|
| | | |
| | | , |
| | | (**) |
| | | |
| | | |
| | | |
| | | |
| | | « / » ^ |
| | | 0,5 |
| | | « / » 5-10 |
| | | |
| | | (-1) |
| | | |

(*) ,
(**) ,

| | | |
|--|--|-------------|
| | | |
| | | , |
| | | |
| | | , , . |
| | | . (**) |
| | | - |
| | | « », , |
| | | , , |
| | | , , |
| | | , , |

(*) ,
(**) ,

1. ()

2.

2

« () »
),

()

01

1 2

»

«

»

»

»

»

»

»

»

»

»

»

»

»

»

»

»

»

»

»

»

»

»

»

»

»

»

»

»

»

»

»

»

»

»

»

»

»

»

»

»

»

»

»

»

»

(*)

02

1

()

« »

4.

1

« »

(*)

04

3.

2

»

05

4.

2

« »

4. 3

».
,
«

07

1,2

».
,
«

08

2, 3 4.

».
,
«

09

1, 2 4

260 , 150

1,3 4

».
,
«

1. :
“ ”).

2. , ,

3. , .

:

-
-
- (SERVICE).

SERVICE 0000 000 00000

- -
 -
- , .

1. .
2. .
3. .
4. (. “ ”).
5. ().

CONTENTS

BEFORE USING THE WASHING MACHINE

- Safety warning
- Recommendations

INSTALLATION

Removal of transportation screws

Adjustment of feet

Electrical connection

Water supply connection

Water drain connection

DESCRIPTION OF THE WASHING MACHINE

WASH PREPARATION

- First wash cycle
- Sorting your laundry
- Placing clothes into the machine
- Filling detergent in the machine

MAINTENANCE AND CLEANING

Water inlet filters

Pump filter

Detergent drawer

Siphon plug

The cabinet

The drum

Removing lime from your machine

TROUBLESHOOTING GUIDE

- Automatic failure detection system

AFTER-SALES SERVICE

TRANSPORT / HANDLING

BEFORE USING THE WASHING MACHINE

Safety warnings

- Do not use a multiple socket or extension cord.
- Do not insert a plug with a damaged or broken cord into the socket.
- If the cord is damaged, it should be replaced by the manufacturer or appointed service agent in order to avoid a hazard.
- Never remove the plug from the socket by pulling from the cord section.

Remove the plug by holding the head of the plug.

- Do not plug the power supply with wet hands.
- Never touch the machine with wet hands or feet.
- Never open the detergent drawer while the device is running.
- Never force open the door of the machine while the machine is running.
- Since the machine can reach high temperatures while running, do not touch the drain hose or water during draining.
- In case of any failure, first unplug the device and close the water tap. Do not attempt to repair. Please consult your nearest authorized service provider.
- Do not forget that the packing material of your machine may be hazardous for children.
- Do not let your children play with the washing machine.
- Keep your pet away from your machine.
- Your machine should only be used by adults in accordance with the instructions written in this manual.
- Your machine is designed for use in a domestic environment. Warranty will be invalid if machine is used for commercial purposes.
- Never use or store flammable materials nearby the appliance.
- To clean the appliance, do not use inflammable cleaning agents.
- The appliance is not to be used by persons (including children) with lowered physical, sensory or mental capacities or with little life experience unless they are under control or instructed by the person responsible for their safety.

Recommendations

- Detergent or softener which is in contact with air for a long time will dry and stick to your detergent drawer. To avoid this, put your detergent and softener into the detergent drawer just before washing.
- It is recommended that you use pre-wash programme for only very dirty clothes.
- Please do not exceed the maximum load capacity.
- If you do not intend to use your machine for a long time, unplug it and close the water supply.
- Leave the door of the machine open after a wash cycle not longer than one hour. This time is enough to keep the inside of the machine dry and to prevent build-up of unpleasant odours. If the door of washing machine will remain opened for a longer period of time, door hinge will become loose, and it can influence the

fixation of the door.

- As a result of quality control procedures, a certain amount of water may remain in your machine.

INSTALLATION

You must pay close attention to the following issues before using your washing machine.

Removal of transportation screws

- Transportation screws, which are located at the rear side of the machine, must be removed before running the machine.
- Loosen the screws by rotating counter clockwise using a suitable wrench. (DIAGRAM-1)
- Remove the screws by pulling them. (DIAGRAM-2)
- This will cause the plastic parts located in the interior part of your machine to drop down under the appliance.
- Lift the machine up slightly to pick up the plastic parts.
- If all of the plastic parts from the screw groups have not dropped down, open the door of your machine, move the drum until all plastic parts drop down. Collect the parts that have fallen to the floor.
- In the holes where the transport screws have been removed, insert the plastic transport screw taps found in the accessories bag. (DIAGRAM-3)
- The transportation screws that have been removed from the machine should be kept safe in the event of future transportation.



DIAGRAM-1

DIAGRAM-2

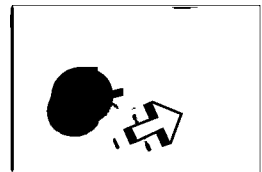
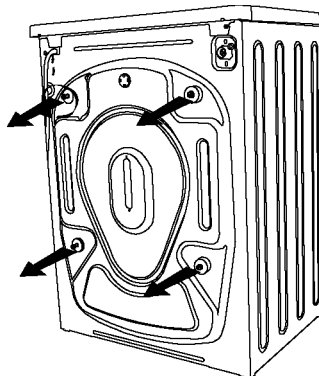

DIAGRAM-3

Adjustment of feet

- Do not install your machine on rugs or similar surfaces.
- For your machine to work silently and without vibrations, it should be settled on a flat, non-slippery and tough surface.
- You can adjust the balance of your machine from its feet.
- First, loosen the plastic adjustment nut.
- Adjust by rotating the feet upwards or downwards.
- After balance has been achieved, tighten the plastic adjustment nut again by rotating it upwards.
- Never put cartons, wooden blocks or similar materials under the machine to adjust the levelness of the machine with the ground.



Electrical connection

- Your washing machine works with 220-240V and 50Hz.
- A special grounded plug has been attached to the network cable of your washing machine. This plug must be inserted to a grounded 10 amp socket. The current rating of the attached electricity supply should also be 10 amps. If you have no such sockets and fuses in your house, the plug should be fitted by a qualified electrician.
- Our company will not be held liable for any damage that may occur as a result of usage without grounding.

Water supply connection

- Depending on the specifications of your machine, it may be provided with a single water inlet (cold) or double water inlet (cold/hot). The white headed hose is for the cold water inlet and red headed hose is for the hot water inlet (for machines with hot & cold water inlet).
- To prevent leakage from the connection joints, 1 (valid for cold water inlet) or 2 (valid for machines with hot & cold water inlet) seals are included in the hose packaging. Fit these seals at the end of water inlet hoses on the tap side.
- Connect the white headed hose to the water inlet valve with white filter and connect the red headed hose to the water inlet valve with red filter (latter in the case of machines with hot & cold water inlet). Manually tighten the connection parts. Please call a qualified plumber for safer connections.

- Water pressure of 1-10 bars {0,1-1,0 MPa} from your tap will enable your machine to work more efficiently (1 bar pressure means water flow of more than 8 litres per minute from a fully opened tap).
- After connections are secure, check for non-leakage of the connection joints by turning on your tap fully.
- Be sure that water inlet hoses are not folded, broken or crushed.
- Mount the water inlet hoses to a 3*74, geared water tap.

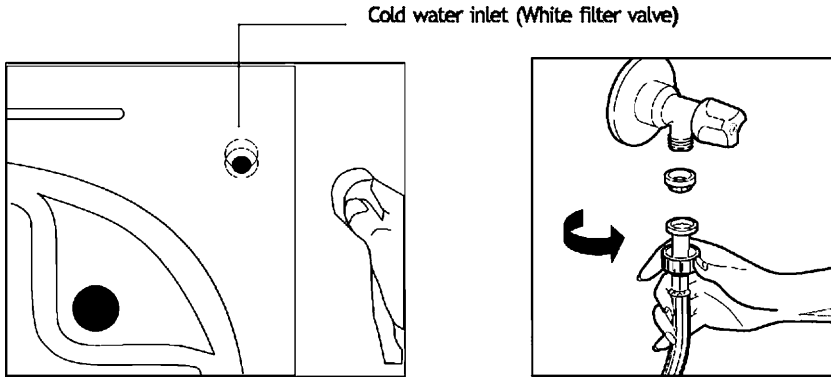

Water drain connection

- Be sure that water inlet hoses are not folded, twisted, crushed or elongated by stretching.
 - « Water drain hose should be mounted at a height of minimum 60 cm, maximum 100 cm from the ground.
 - The end of the water drain hose may be directly fitted to the dirty water outlet hole or a special apparatus mounted on the outlet bracket of the wash-stand.
 - Never attempt to extend the water drain hose by adding extra parts.
 - We recommend that you use only new water hoses supplied with the appliance.
- You must not use the water hoses that have already been in use.

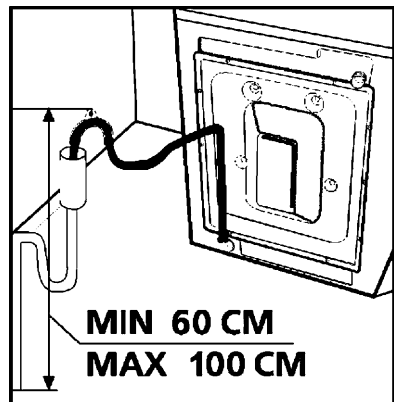

DESCRIPTION OF THE WASHING MACHINE

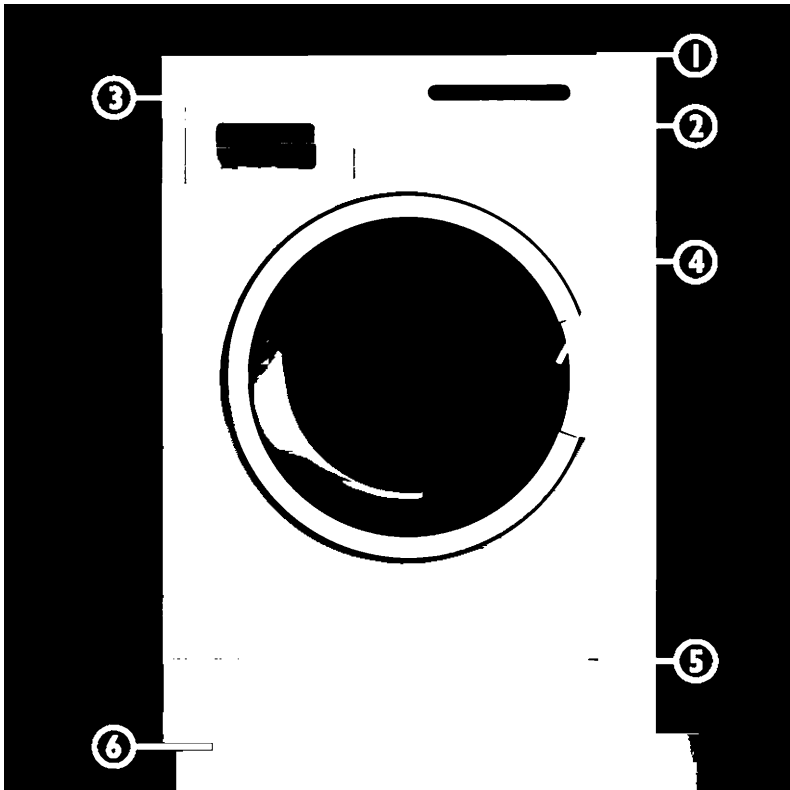

- 1 - Worktop
- 2 - Control panel
- 3 - Detergent drawer
- 4 - Door
- 5 - Plinth covering pump access
- 6 - Adjustable feet

PREPARATION OF THE WASHING

- Plug in the machine.
- Open the water tap.

First wash cycle

There may be water left inside your machine after factory tests and trials. It is recommended that the first wash cycle should be made without any laundry to drain this water; pour half a measuring cup of normal all-purpose detergent into compartment 2 and select cotton programme at 90 °C.

Sorting your laundry

- Sort your clothes according to their types (cotton, synthetic, sensitive, woollen, etc.), washing temperatures and level of dirtiness.
- Never wash your white and coloured clothes together.
- Since your new coloured clothes may shed dye on the first wash, wash them separately.
- Be careful that no metal pieces are found on or in the pockets of your clothes, remove if necessary.
- Zip and button your clothes.
- Remove plastic or metal hooks from curtains and laces or place them inside a washing bag and tie.
- Turn textiles such as trousers, knitted fabrics, t-shirts and sweat shirts inside out.
- Wash small clothing items such as socks and handkerchiefs in a washing bag.

Wash up to 90°C

Wash up to 60°C

Wash up to 30°C



Not washable in
washing machine

Placement of the clothes into the machine

- Open the door of your machine.
- Fill your clothes in your machine in an evenly-spread manner.
- Place each clothing item into the machine separately.
- When you shut the door of your machine, be careful that no clothing item is jammed between the cover and the gasket.
- Shut the door of your machine tightly otherwise your machine will not begin the washing process.

Filling detergent in the machine

The quantity of the detergent that you will fill in your machine depends on the following criteria:

- Your detergent consumption will change according to the level of dirtiness of your clothes. For your slightly dirty clothes, do not pre-wash and put a small amount of detergent in the compartment no.2 of the detergent drawer.
- For your excessively dirty clothes, select a programme with pre-wash, fill portion of the detergent you will put in compartment 1 in the detergent drawer and the remaining portion in compartment 2.
- In your machine, use detergents developed especially for automatic washing machines. The quantities that will be used for your clothes are written on the packaging of the detergents.
- As the hardness of your water increases, the amount of detergent to be consumed will also increase.
- As the amount of your clothes increases, the amount of detergent to be consumed will also increase.
- Pour your softener into the softener compartment of your detergent drawer. Do not exceed the AAAX level. Otherwise, the softener will diffuse into the washing water via the siphon.
- Concentrated softeners should be diluted with water before pouring into the drawer. This is because concentrated softener obstructs the siphon and prevents the flow of the softener.
- You can use fluid detergents in all programmes without pre-washing. For this, add the fluid detergent separator to the second compartment of the detergent drawer and regulate the amount of fluid detergent according to the levels on this plate.

WARNING!

In the event that power is cut off at any stage of the wash programmes and then later reconnected, your machine will continue the programme from the point it was interrupted at. Such a situation will not cause any harm to your machine.

In the event that power is cut off during the wash operation, the door lock mechanism will be released after two minutes. If there is water in the machine do not open the door, in order to prevent water from pouring out. If you wish to take out your laundry you can do so by draining the water inside the machine.

AAINTENANCE AND CLEANING

- Unplug your machine.
- Close the water tap.

Water in let filters

On the tap part of your machine's water inlet hose and at the extremities of the water inlet valves, there are filters to prevent entrance of dirt and foreign bodies into the water to the machine. If the machine is unable to receive sufficient water although your water tap is opened, these filters should be cleaned.

- Remove the water inlet hose.
- Remove the filters found on the water inlet valves by using tweezers or pliers and wash thoroughly with a brush.
- Clean the filters of the water inlet hoses located on the tap side by removing manually, together with the seal.
- After cleaning the filters, they can be refitted by reversing the removal procedure.

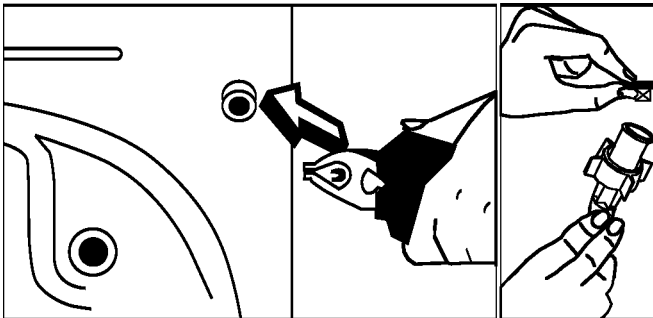

Pump filter

The pump filter system prolongs the life of your pump, which is used to drain the dirty water. It prevents lint from entering the pump. Cleaning your pump filter every 2-3 months is recommended. To clean your pump filter:

- Remove the kickplate by pushing upwards with your hand from the lower claws and pulling towards yourself.
- Before opening the filter cover, place a cup in front of the filter cover to prevent flow of the remaining water in the machine.
- Loosen the filter cover by turning counter clockwise and drain the water.
- Remove the foreign bodies from the filter.
- Check for the rotation of the pump manually.
- After you have cleaned the pump, refit the filter cover by rotating clockwise.
- Refit the kickplate by holding from the claws and pushing it.
- Do not forget that if the filter cover is not properly refitted, it will leak water.

WARNING!

Danger of scalding!

Since the water inside the pump may be hot, wait for it to cool.

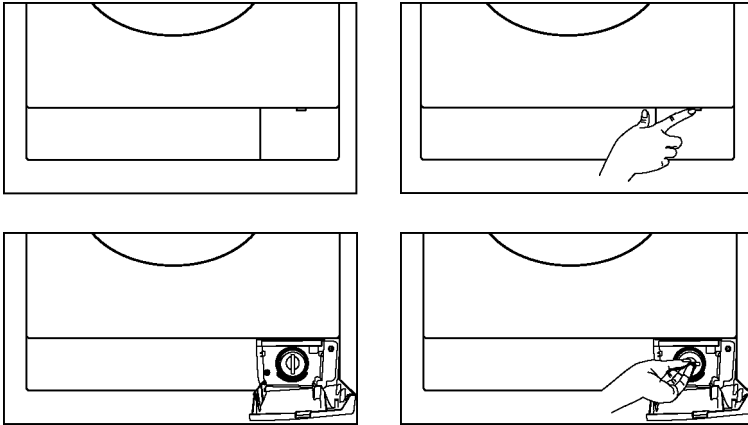

Detergent drawer

Detergents may cause residue build-up in the detergent drawer and its slot over time. Take out the detergent drawer periodically to clean away the accumulated residue. To remove the drawer, proceed as follows:

- Pull the drawer to its end (DIAGRAM-1).
- Keep pulling by pressing on the siphon lid inside the drawer which is fully pulled to its end, and remove the drawer from its place (DIAGRAM-2).
- Wash it by rinsing with water and cleaning with an old toothbrush.
- Collect the residue inside the drawer slot without letting it drop into the machine.
- After thoroughly drying the drawer, refit by reversing the removal procedure.

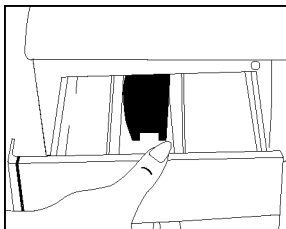

DIAGRAM-1

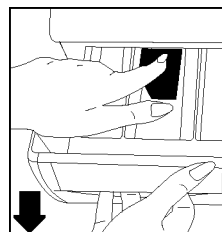
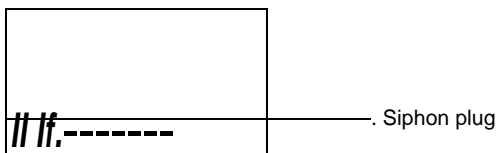

DIAGRAM-2

Siphon plug

Pull out the detergent drawer. Remove the siphon plug and thoroughly clean any softener residue. Refit the cleaned siphon plug back in its place. Check that it is fitted properly.



The cabinet

To clean the outside of the appliance, use a neutral detergent and a damp cloth. Please be careful not to use material that could damage the exterior surface of your machine.

WARNING!

If the machine is installed in a location where the ambient temperature can fall below 0 °C, proceed as follows when not in use:

Plug in the machine.

Close the water tap and pull out the water inlet hose or hoses from the tap.

Place the ends of the water drain and water inlet hoses in a cup on the ground.

Adjust the programme knob to "Draining" programme.

The programme ready light will be on.

Run the programme by pressing the start/pause button.

Unplug your machine when the programme is over (programme end light is on).

When this process is completed, the remaining water inside the machine will be drained and thus formation of ice in the machine will be prevented. When you operate your machine again, be sure that the ambient temperature is above 0 °C.

The drum

Do not leave metal parts such as needles, staples or coins inside your machine. These pieces cause rust stains to form inside the drum. To eliminate these rust stains, use a non-chlorine cleaning agent and follow the warnings of the cleaning agent producer. Never use dish-washing scourers or similar abrasive objects to clean rust stains.

Remove of lime from your machine

If you regulate the amount of detergent used in your machine properly, there will be no need for lime removal. However, if you desire to apply the removal procedure, use lime protectors readily available on the market and pay attention to their warnings.

WARNING!

The lime-eliminating substances contain acids and this may cause colour modifications in your clothes along with an adverse effect on your machine.

TROUBLESHOOTING GUIDE

All repairing which must be done on the machine should be performed by authorized service personnel. When your machine requires repairs or you are unable to eliminate the failure with the help of the information given below:

- Unplug the machine.
- Close the water tap.
- Consult your nearest authorized service provider.

| Failure | Probable cause | Methods of elimination |
|--------------------------------------|--|---|
| Your machine does not operate. | It is unplugged. | Insert the plug into the socket. |
| | Your fuse is defective. | Change your fuse. |
| | The electric power is off. | Check the electric power. |
| | Start/pause button has not been pressed. | Press the start/pause button. |
| | The programme knob is in 0 (off) mode. | Turn the programme knob to the desired mode. |
| | The door is not shut properly. | Shut the door properly. You should hear it click. |
| Your machine does not receive water. | Water tap is closed. | Open water tap. |
| | The water inlet hose may be bent. | Check the water inlet hose. |
| | The water inlet hose is destructed. | Clean the filters of water inlet hose. (*) |
| | The valve inlet filter is obstructed. | Clean the valve inlet filters. n |
| | The door is not shut properly. | Shut the door properly. You should hear it click. |
| Your machine is not draining water. | The drain hose is obstructed or bent. | Check the drain hose. |
| | The pump filter is obstructed. | Clean the pump filter. (*) |

(*) See the section concerning maintenance and cleaning of your machine.

(**) See the section concerning installation of your machine.

| Failure | Probable cause | Methods of elimination |
|---|--|--|
| Your machine is vibrating. | The clothes are not placed inside the machine in an evenly-balanced manner. | Spread the clothes inside the machine in an orderly and evenly-balanced manner. |
| | The feet of your machine are not adjusted. | Adjust the feet. (**) |
| | Transportation screws are not removed. | Remove transportation screws. (**) |
| | There is a small amount of clothes in the device. | It does not prevent operation of the machine. |
| | Excessive amount of clothes are filled in the machine or the clothes are not placed in a well-balanced manner. | Do not exceed the recommended quantity of clothes and spread your clothes in the machine in a well-balanced manner. |
| | Your machine touches a rigid object. | Prevent your machine's leaning on a tough place. |
| Excessive foam in the detergent drawer. | Too much detergent has been used. | Press the start/pause button. In order to stop the foam, dilute one table-spoon of softener in half liter of water and pour it in the detergent drawer. Press the start/pause button after 5-10 minutes. Arrange the amount of the detergent properly in the next washing process. |
| | Wrong detergent has been used. | Use only the detergents produced for full automatic machines. |
| The washing result is bad. | Your laundry too dirty for the program you have selected. | Select a suitable program, (see Table-1) |
| | The amount of detergent used is not sufficient. | Use more detergent according to the detergent. |

(*) See the section concerning maintenance and cleaning of your machine.

(**) See the section concerning installation of your machine.

| Failure | Probable cause | Methods of elimination |
|--|--|--|
| Washing quality is poor. | Machine load exceeds maximum capacity. | Load clothes into your machine so as to avoid exceeding its maximum capacity. |
| | Your water may be hard. | Regulate the amount of detergent used according to the detergent producer's guidelines. |
| | Distribution of the clothes in your machine is not evenly-balanced. | Spread the clothes inside the machine in an orderly and evenly-balanced manner. |
| The water is drained from the machine as soon as it is filled. | The end of the water drain hose is positioned too low in relation to the machine. | Place the water drain hose at an appropriate height. (**) |
| No water is seen in the drum during washing. | No failure. The water is in the lower part of the drum. | - |
| There is detergent residue on the clothes. | Undissolved fragments of certain detergents may stick to your clothes as white stains. | By calibrating your machine for "Rinsing" programme, run an additional rinse or eliminate stains after drying with the help of a brush. |
| There are grey stains on the clothes. | These stains may be caused by oil, cream or ointment. | Use the maximum detergent amount recommended by the detergent producer during the next washing operation. |
| The spinning process is not done or starts with delay. | No failure. The unbalanced load control may operate in that way. | The unbalanced load control system will try to distribute your clothes in a homogenous manner. After your clothes are distributed, the spinning process will begin. For the next wash, place your clothes into the machine in an evenly-balanced manner. |

(*) See the section concerning maintenance and cleaning of your machine.

(**) See the section concerning installation of your machine.

AUTOAATIC FAILURE DETECTION SYSTEM



Your machine is equipped with systems which will both take the necessary precautions and warn you in case of any failure by continually monitoring the washing processes.

| Failure code | Failure indicator | Probable failure | Corrective measures |
|-------------------------|---------------------------|--------------------------------|---|
| FOR ALL FAILURES | More than one light blink | Any kind of failure | <p>First Intervention for any kind of failure</p> <p>Turn the program knob to the 0 (off) position.</p> <p>1. Be sure that the selected program is used properly, please check on the program chart the kind of laundry it is suitable for and the maximum load allowed. If the laundry and the program are not consistent, then choose the correct program and follow the steps below.</p> <p>2. If the program and the laundry type are consistent and problem available, after waiting for 2 minutes, start the consistent program for your laundry type. After this intervention, if the problem still continues, then make reset of electronic card (see programme chart «Cancel a running programme»), wait for the reset is finished. Then turn the program to stop position and choose the consistent program for your laundry type and start it.</p> <p>Shut the door properly so that you hear it click. If the problem persists, follow 'for all failures' instructions.</p> <p>In the case that problem still continues. Turn off the machine, unplug it and consult your nearest authorized service provider.</p> |
| | Lights 1 and 2 blink. | The door is not shut properly. | |

E01



(*) See the section concerning maintenance and cleaning of your machine.

| Failure code | Failure indicator | Probable failure | Corrective measures |
|--------------|---|--|---|
| E02 |  | <p>Lights 1 and 3 blink.</p> <p>The water level in your machine is below heater. The pressure of your water supply may be low or unstable.</p> | <p>Turn on the tap to the end. Water supply may be cut, check it. If the problem still exists, your machine will automatically stop after a while. Check water entry filter: close the tap, disconnect water entry hose from the machine, and check if the filters (net) in the hose and in the machine are obstructed. Clean filters if necessary. If the problem persists, follow 'for all failures' Instructions.</p> <p>In the case that problem still continues, unplug your machine, turn off the tap and consult your nearest authorized service provider.</p> |
| E03 | | <p>Lights 1 and 4 blink.</p> <p>The pump has failed or the pump filter is obstructed, or drain is in open circuit.</p> | <p>Clean the pump filter. If the problem persists, follow 'for all failures' Instructions.</p> <p>In the case that problem still continues, consult your nearest authorized service provider. (*)</p> |
| E04 |  | <p>Lights 2 and 3 blink.</p> <p>There is an excessive amount of water in your machine.</p> | <p>Your machine will automatically drain the water. After your machine has completed the draining process. If the problem persists, follow 'for all failures' Instructions.</p> <p>In the case that problem still continues, shut down your machine and unplug. Close the tap and consult your nearest authorized service provider.</p> |
| EOS |  | <p>Lights 2 and 4 blink.</p> <p>The heater of your machine or the heat sensor has failed.</p> | <p>The scum can become a reason of this failure. Clean the machine with a special anti-lime remedy following the Instructions on packing. If the problem persists, follow 'for all failures' Instructions.</p> <p>In the case that problem still continues, shut down and unplug your machine. Turn off your tap and consult your nearest authorized service provider.</p> |

| Failure code | Failure indicator | Probable failure | Corrective measures |
|--------------|--------------------------|---|---|
| E06 | Lights 3 and 4 blink. | The motor has failed. | <p>Follow 'for all failures' instructions.</p> <p>In the case that problem still continues, shut down and unplug your machine, turn off the tap and consult your nearest <u>authorized service provider.</u></p> <p>Follow 'for all failures' instructions.</p> |
| E07 | Lights 1, 2 and 3 blink. | Electronic card has failed. | <p>In the case that problem still continues, shut down and unplug your machine. Turn off the tap and consult your nearest <u>authorized service provider.</u></p> <p>Follow 'for all failures' instructions.</p> |
| EOS | Lights 2, 3 and 4 blink. | The motor has failed. | <p>In the case that problem still continues, shut down and unplug your machine, turn off the tap and consult your nearest <u>authorized service provider.</u></p> |
| E09 | Lights 1, 2 and 4 blink. | The network voltage is too high or too low. | <p>If the network voltage is lower than 150V or higher than 260V, your machine will automatically stop. When the network voltage is recovered, your machine will <u>continue its operation.</u></p> <p>Follow 'for all failures' instructions.</p> |
| E10 | Lights 1, 3 and 4 blink. | Communication error. | <p>In the case that problem still continues, shut down and unplug your machine. Turn off the tap and consult your nearest <u>authorized service provider.</u></p> |



AFTER-SALES SERVICE

Before contacting After-Sales Service:

1. Try to remedy the problem yourself (see “Troubleshooting Guide”).
2. Restart the programme to check whether the problem has solved itself.
3. If the washing machine continues to function incorrectly, call the After-Sales Service.

Specify:

- The nature of the problem.
- The washing machine model.
- The service code (number after the word SERVICE).

SERVICE 0000 000 00000

The After-Sales Service sticker can be found inside the door.

- Your full address.
- Your telephone number and area code.
- After-Sales Service phone numbers and addresses are given on the guarantee card. Alternatively, consult the dealer where you purchased the appliance.

TRANSPORT / HANDLING

Never lift the appliance by the worktop when transporting.

1. Pull out the mains plug.
2. Turn off the tap.
3. Disconnect the inlet and drain hoses.
4. Drain all water from the hoses and from the appliance (see “Removing the Filter”, “Draining Residual Water”).
5. Fit the transportation screws (obligatory).

NOTES

NOTES

NOTES

NOTES

- : -
601655 . , ..
. . 16
.: (495) 980-50-43
: (49244) 6-91-68

8
→ 00
5

11

:= <



00 =

2. ^
:£